

# P2211 Flush valve Installation Instruction

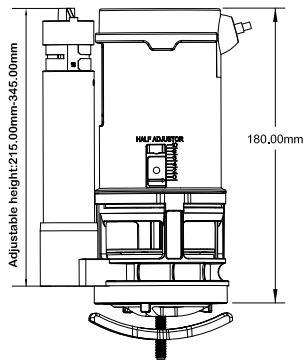

Flush valve diagram

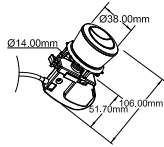

## Instructions:

1. Please read carefully the following installation instructions, in order to avoid component damage or injury to the installer.
2. Please do not use detergent or solvent corrosion in tank, or any related chemical related components, we shall not responsible for failures that related to this.
3. We shall not responsible for failures that are contributed to the use of parts other than those specified.
4. Water Temperature: 4℃-45℃
5. We reserve the right make modifications to the package and specifications without providing prior notification, details please refer to the products which you received.

**Work Preparation:** Remove the inoperative tank fittings and carefully clean the water tank. Make sure all debris has been removed prior to installing new tank fittings.

## 1、 Flush valve for two piece toilet installation

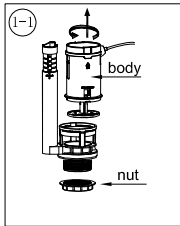

Unscrew and put down the nut and body of the valve.

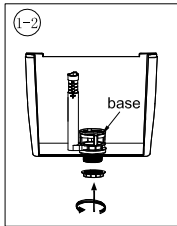

Insert the base into outlet hole and screw the nut.

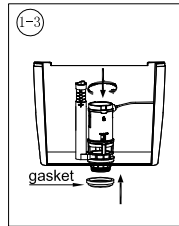

Install the body of valve and gasket.

## 2、 Flush valve for one piece toilet installation .

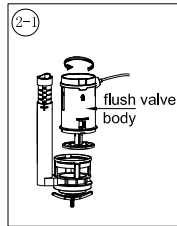

Remove body of the valve.

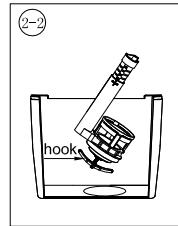

Rotate the metal anchor to the bottom of the bolt, place one end of the metal anchor into the ceramic hole and then the other end.

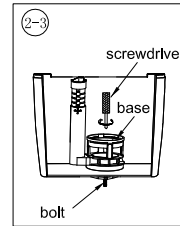

Use a screwdriver to tighten the bolt sufficiently to avoid leakage.

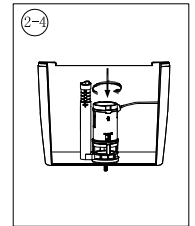

Installation body.

## 3、 Adjustment of flush volume

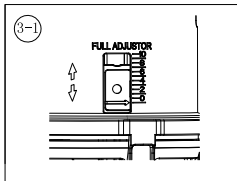

Full adjuster down, full flush volume increases. Vice versa.

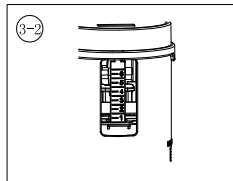

Float cup down, half flush volume increases. Vice versa.

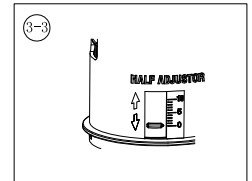

Half adjuster down, half flush volume increases. Vice versa.

## 4、 Side push button installation

### 4-1 Option 1:

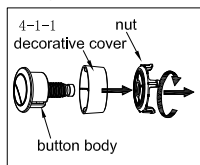

Unscrew the nut and decorative cover.

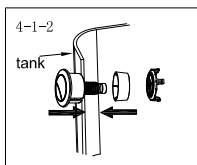

Insert push button body into ceramic hole, then screw the decorative cover and tighten the nut.

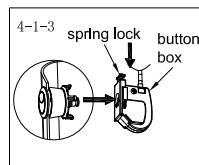

Press the spring lock, insert the button body into the button box hole.

### 4-2 Option 2:

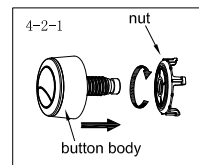

Unscrew the nut.

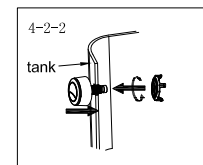

Insert push button body into ceramic hole, then tighten the nut.

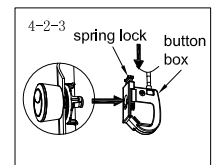

Press the spring lock, insert the button body into the button box hole.

## 5、 Top push button installation

### 5-1 Option 1:

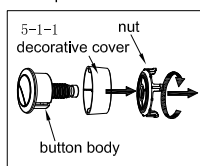

Unscrew the nut and decorative cover.

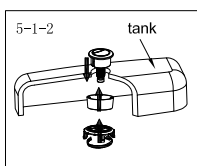

Insert push button body into ceramic hole, then screw the decorative cover and tighten the nut.

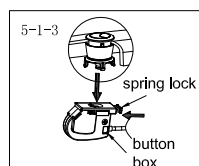

Press the spring lock, insert the button body into the button box hole.

### 5-2 Option 2:

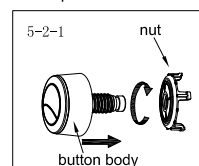

Unscrew the nut.

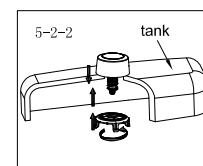

Insert push button body into ceramic hole, then tighten the nut.

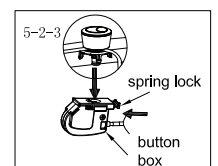

Press the spring lock, insert the button body into the button box hole.

## 6、 Troubleshooting of flush valve:

Issue	cause	Resolution
Leakage	The sealing washer does not properly fit	Please remove then reassemble
Full flush or half flush water level is too high or too low	Full flush adjuster and half float cup do not have correct position.	Readjust full flush adjuster and half float cup.